

SECTION BREAKDOWN INFORMATION

Scale: 1" = 1000'

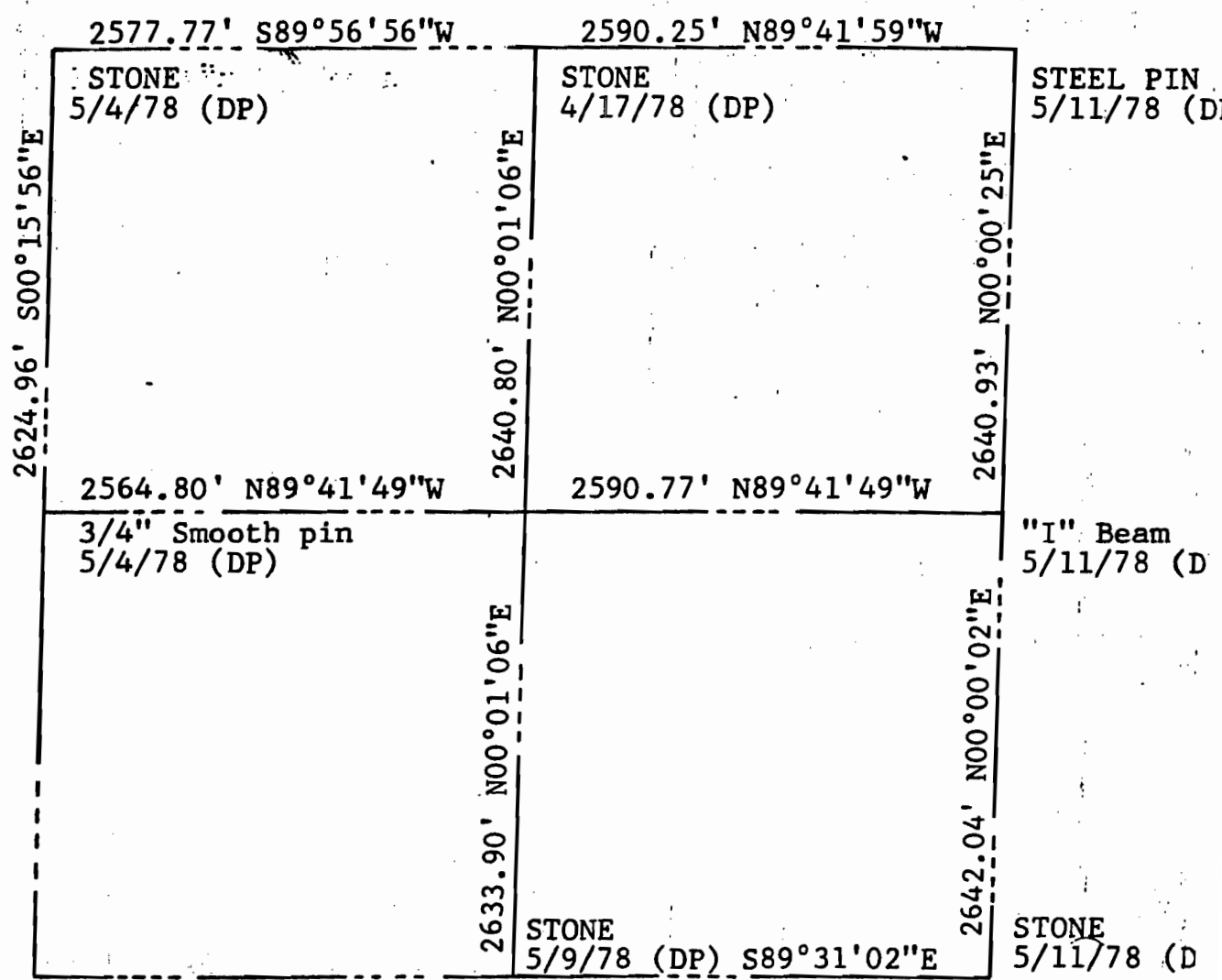

ANGULAR ERROR OF CLOSURE: 00°00'14.75" 2591.64'
 LINEAR ERROR OF CLOSURE AFTER ANGULAR ADJUSTMENT: 0.32'
 TOTAL TRAVERSE LENGTH: 25155.91'
 SURVEY PRECISION: 1: 78,590
 JOB NO.: DE 0274

SECTION 26, TOWNSHIP 4 SOUTH, RANGE 70 WEST
 DATA BY: Steven C. Steinberger and Crew
 DATE: April 14, 17 & 19 and May 8, 1978
 BASIS OF BEARINGS: East Line of SE 1/4 assumed N00°00'02"E

