

City of Lakewood, Colorado
 Public Works Department
 Engineering Division
 303-987-7900
 www.lakewood.org

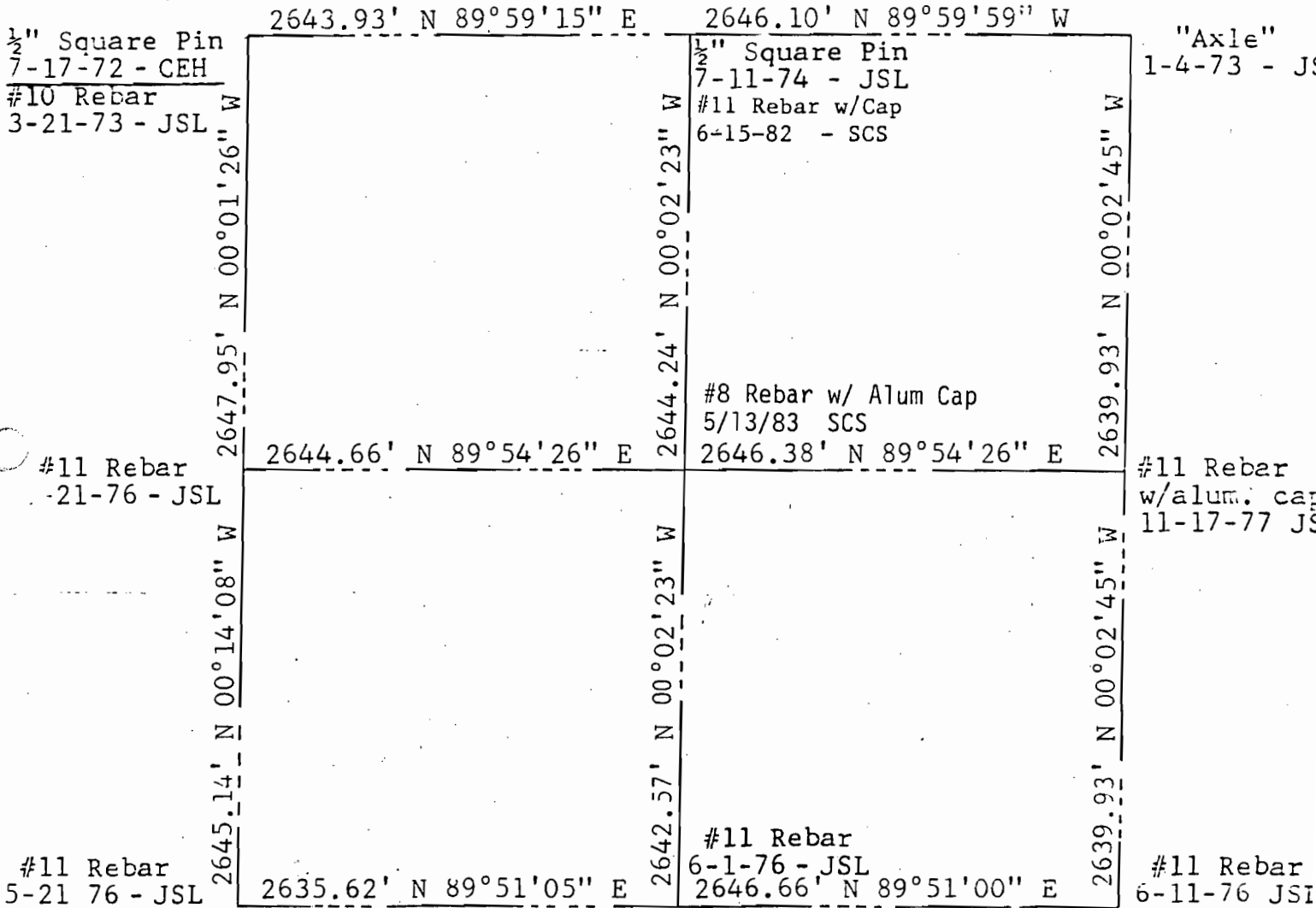

Scale: 1" = 1000'

SECTION BREAKDOWN INFORMATION



ANGULAR ERROR OF CLOSURE: 00°00'00.25"
 LINEAR ERROR OF CLOSURE AFTER ANGULAR ADJUSTMENT: 0.21'
 TOTAL TRAVERSE LENGTH: 21,151.50'
 SURVEY PRECISION: 1/102,767
 JOB NO.: AG 27-76

SECTION 36, TOWNSHIP 3 SOUTH, RANGE 69 WEST
 DATA BY: John Lambert
 FIELD DATE: Sept. 22 and Sept. 26, 1977
 BASIS OF BEARINGS: The North line of the Northeast Quarter (NE 1/4) assumed N 89°59'59" W

City of Lakewood, Colorado
 Public Works Department
 Engineering Division
 303-987-7900
 www.lakewood.org



SECTION BREAKDOWN INFORMATION

EDGEWATER SUBDIVISION

Scale: 1" = 1000'

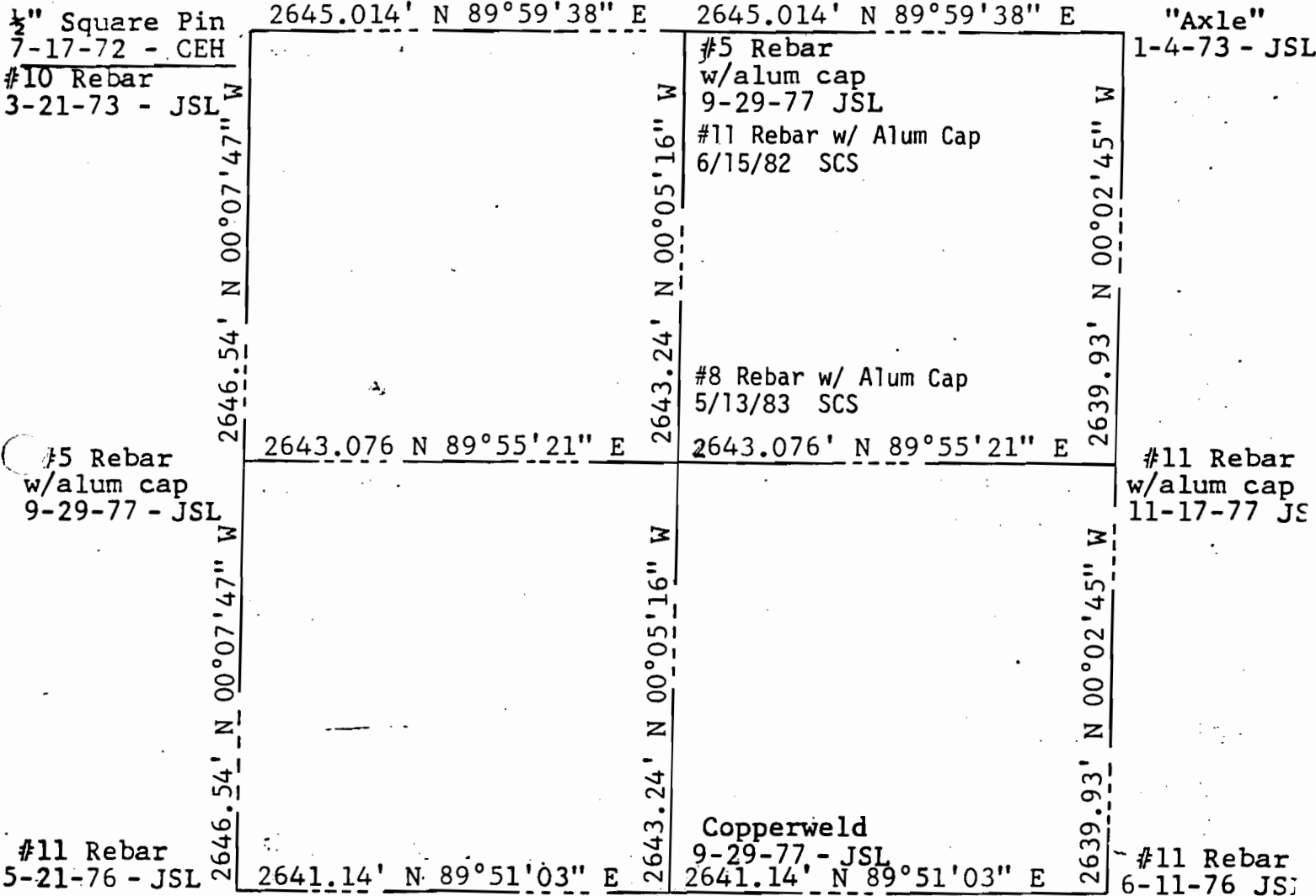

ANGULAR ERROR OF CLOSURE: 00°00'00.25"
 LINEAR ERROR OF CLOSURE AFTER ANGULAR ADJUSTMENT: 0.21'
 TOTAL TRAVERSE LENGTH: 21,151.50'
 SURVEY PRECISION: 1/102,767
 JOB NO.: AG 27-76

► Plat of Edgewater Subdivision ◀
 SECTION 36, TOWNSHIP 3 SOUTH, RANGE 69 WEST
 DATA BY: John Lambert

FIELD DATE: Sept. 22, and Sept. 26, 1977
 BASIS OF BEARINGS: The North line of the Northeast Quarter (NE¼) assumed N 89°59'38"E